

Aluminum Extrusions (HFS8-45 Series)

45, 90 mm Square – 1 Slot

HFS8-45 Series		Fixing Parts			Others	
Brackets	Nuts	Joints	Extrusion End Caps	Alteration		
P.2816-2830	P.2831-2838	P.2842-2857	P.2839-2841	P.2862-2863		

HFS8 Series Aluminum Extrusions – 45, 90 mm Square – 1 Slot

RoHS10



Type		Material	Surface Treatment
Configurable Length	Fixed Length		
GFS 8	KGFS 8	A6061SS-T6 Equivalent	Clear Anodize
HFS 8	KHFS 8		
HFSL 8	KHFSL 8	A6N01SS-T5 Aluminum Alloy	Black Anodize
HFSB 8	KHFSB 8		

⊕ Cut surface and altered parts are not surface treated.

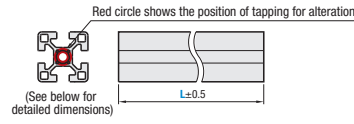

Slot (Common in HFS / CAF / GFS series)

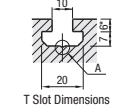

** 5.5 for Light Type (HFSL, HFSLF, HFSLT).

Details of slot bottom (HFS / CAF Series)

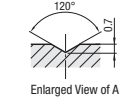

(GFS Series)

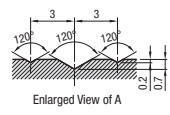

Features of Extrusions

Surface Treatment	Features of Extrusions	
	HFS Extrusions	Standard cross section shape.
HFSL Extrusions	Although having thin walls lowers the allowable load, excels in cost savings offered.	
GFS Extrusions	Suitable for heavier devices due to the thick walls.	
Clear Anodize	Common surface treatment.	
Black Anodize	Effective in where light reflection is not desirable.	

HFST8-4545
HFSTB8-4545 (Black Anodize)

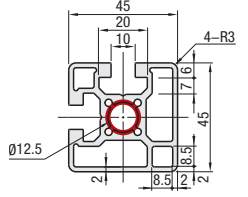

HFSLT8-4545 (Light Type)

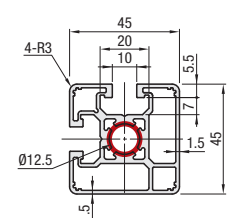

GFST8-4545 (High Rigidity)

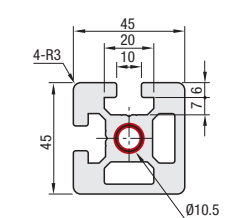

HFSH8-4545

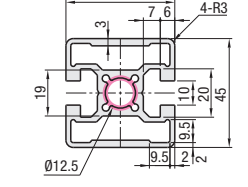

HFSC8-4545

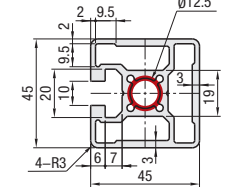

Configurable Length Extrusions

Part Number	L 0.5 mm Increment	Mass kg/m	Sectional Area mm ²	Cross Sectional Moment of Inertia mm ⁴	
				ξx	ξy
HFST8	4545	50-4000	713	14.00 x 10 ⁴	14.00 x 10 ⁴
HFSTB8 Black Anodize					
HFSLT8 Light Type					
GFST8 High Rigidity					
HFSH8					
HFSC8					

Fixed Length Extrusion (Effective Length 4,000 mm, 1,000 mm)

⊕ Part numbers beginning with the character "K" indicate Fixed Length Extrusion.

Part Number	L mm	Sectional Area mm ²	Cross Sectional Moment of Inertia mm ⁴	
			ξx	ξy
KHFST8	4545	713	14.00 x 10 ⁴	14.00 x 10 ⁴
KHFSTB8 Black Anodize				
KHFSLT8 Light Type				
KGFS8 High Rigidity				
KHFSH8				
KHFSC8				

Part Number Example	Part Number	-	L
	HFST8-4545	-	800
	KHFST8-4545	-	4000

Aluminum Extrusions (HFS8-45 Series)

45, 90 mm Square – 2 Slots

HFS8-45 Series		Fixing Parts			Others	
Brackets	Nuts	Joints	Extrusion End Caps	Alteration		
P.2816-2830	P.2831-2838	P.2842-2857	P.2839-2841	P.2862-2863		

HFS8 Series Aluminum Extrusions – 45, 90 mm Square – 2 Slots

RoHS10



Type		Material	Surface Treatment
Configurable Length	Fixed Length		
—	KGFS8	A6063S-T6	Clear Anodize
GFS8	KGFS8	A6061SS-T6 Equivalent	
HFS8	KHFS8	A6N01SS-T5 Aluminum Alloy	Black Anodize
HFS 8	KHFS 8		
HFSB8	KHFSB8	6005A-T5 Aluminum Alloy	Clear Coating (Clear Anodize + Clear Painting)
CAF8	KCAF8		

⊕ Cut surface and altered parts are not surface treated.

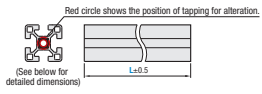

* 5.5 for Light Type (HFSL).

Slot (Common in HFS / CAF / GFS series)

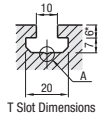

Details of slot bottom (HFS / CAF Series)

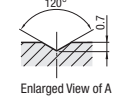

(GFS Series)

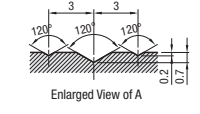

HFS8-4590
HFSB8-4590 (Black Anodize)
CAF8-4590 (Clear Coating)

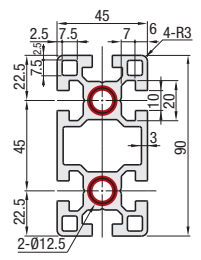

HFSL8-4590 (Light Type)
⊕ Use HSCA8 as a slot cover for HFSL8-4590. (Refer to P.2809)

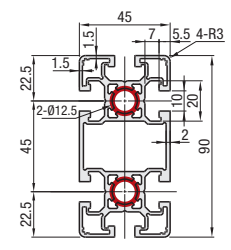

GFS8-4590 (High Rigidity)

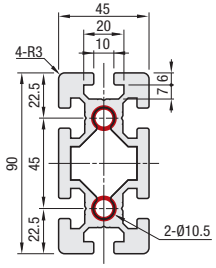

HFSF8-4590

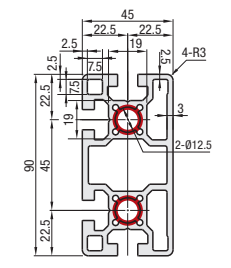

Configurable Length Extrusions

Part Number	L 0.5 mm Increment	Mass kg/m	Sectional Area mm ²	Cross Sectional Moment of Inertia mm ⁴	
				ξx	ξy
HFS8	4590	50-4000	1534	32.29 x 10 ⁴	124.7 x 10 ⁴
HFSB8 Black Anodize					
CAF8 Clear Coating					
HFSL8 Light Type					
GFS8 High Rigidity					
HFSF8					

Fixed Length Extrusion (Effective Length 4,000 mm, 1,000 mm)

⊕ Part numbers beginning with the character "K" indicate Fixed Length Extrusion.

Part Number	L mm	Sectional Area mm ²	Cross Sectional Moment of Inertia mm ⁴	
			ξx	ξy
KHFS8	4590	1534	32.29 x 10 ⁴	124.7 x 10 ⁴
KHFSB8 Black Anodize				
KCAF8 Clear Coating				
KHFSL8 Light Type				
KGFS8 High Rigidity				
KHFSF8				

Part Number Example	Part Number	-	L
	HFS8-4590	-	800
	KHFS8-4590	-	4000